

BRAND NEW 1 & 2 BEDROOM APARTMENT HOMES

55+ Active  
Adult Living

[SoleaLewisville.com](http://SoleaLewisville.com)

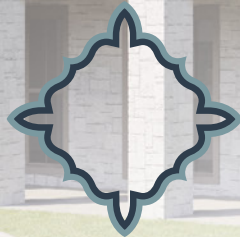

SOLÉA

LEWISVILLE





# LIMITLESS EXPERIENCES AT SOLÉA LEWISVILLE

Soléa Lewisville is a resort-style, 55+ Active Adult Living apartment home community.

We offer an incredible stress-free, maintenance-free living experience rich with activities and new friends. Thoughtfully situated within a vibrant local neighborhood, everything about Soléa Lewisville is created with a truly active lifestyle in mind.

In your new, beautifully designed one or two-bedroom apartment home you will have full access to our extensive community features, programs, and resort-style amenities where we provide abundant opportunities to socialize, be active, and enjoy your hobbies.

How do we make it happen? With a friendly service team and supportive community staff, we give you the freedom to enjoy every day, and leave the rest up to us!

**Now is your time to thrive!**



## **BE SOCIAL**

Weekly happy hour, daily fitness classes, water aerobics, Bridge club, wine tastings, cooking classes, community gardening, group outings, bingo and games, line dancing, book club, movie nights, potlucks, and much more.

## **HEALTH & FITNESS**

No matter your fitness level, learn how to feel your best with on-site classes focused on nutrition, physical and mental health. We make it a priority to plan and provide a variety of programs and activities to help our residents feel great every day.

## **SERVICE TEAM**

On-site technicians are here to help with the ins and outs that make your home perfect. Need a repair or help with an appliance? We're on our way!

## **PET FRIENDLY**

Your furry friends are welcome here. While they're enjoying our private dog park, you might make some new two-legged friends yourself!



# COMMUNITY AMENITIES

- Resort-style Pool with Sun Deck
- Manicured Courtyard
- Pickle Ball Court
- Bocce Court
- Event Lawn
- Courtyard Firepit
- Community Garden with Raised Garden Beds
- Pet Friendly\*
- Dog Park
- Outdoor Kitchen and Grilling Stations
- Outdoor Covered Patio
- Outdoor Bike Rack Storage
- 9,000 Sq. Ft. Two Story Community Clubhouse
- 24-Hour Wellness and Fitness Studios
- Weekly Fitness Classes
- Social Events Calendar
- Elevator Service
- Clubroom Lounge and Community Kitchen with Coffee Bar & Wine Fridge
- Library
- Game Room
- Craft Room
- Business Center with Wi-Fi Access
- Controlled Access Gates
- Detached Garages and Carports
- Additional Storage Units
- Smoke Free Community
- Climate Controlled Interior Corridors

\*Breed restrictions apply



# APARTMENT AMENITIES

- Open Concept Floor Plan Design
- Walk-In Closets
- 9' Ceilings
- Private Yards with Direct Gate Access\*
- Private Terrace/Balconies
- Walk-In Showers
- Garden Tubs\*
- Granite Countertops
- Dual Vanities\*
- Stainless Steel Appliances
- Vinyl Plank Flooring in Living Areas, Kitchens & Bathrooms
- Carpet in Bedrooms
- In Unit Washer and Dryer

\*Select floorplans





**A1**

**THE VERONA**



**1 BED 1 BATH**

615 SF

**A2**

**THE MILAN**



**1 BED 1 BATH**

667 SF



### THE TORINO



### 1 BED 1 BATH

678 SF



### THE GENOA



### 1 BED 1 BATH STUDY

893 SF

**A5**

**THE FLORENCE**



**1 BED 1 BATH STUDY**

1,018 SF

**A5A**

**THE FLORENCE**



**1 BED 1 BATH**

885 SF



# B1

## THE VENICE



### 2 BED 2 BATH

917 SF

# B2

## THE SAN MARINO



### 2 BED 2 BATH

993 SF



**B3**

**THE PALERMO**



**2 BED 2 BATH**

1,165 SF

**B4**

**THE TRENTO**



**2 BED 2 BATH STUDY**

1,285 SF



**B4A**

**THE TRENTO**



**2 BED 2 BATH STUDY**

1,326 SF



**OUR FLOORPLANS**





UNIT TYPES	
<b>A1</b>	THE VERONA 1 Bed, 1 Bath 615 SF
<b>A2</b>	THE MILAN 1 Bed, 1 Bath 667 SF
<b>A3</b>	THE TORINO 1 Bed, 1 Bath 678 SF
<b>A4</b>	THE GENOA 1 Bed, 1 Bath 893 SF
<b>A5</b>	THE FLORENCE 1 Bed, 1 Bath 1,018 SF
<b>A5 A</b>	THE FLORENCE 1 Bed, 1 Bath 885 SF
<b>B1</b>	THE VENICE 2 Bed, 2 Bath 917 SF
<b>B2</b>	THE SAN MARINO 2 Bed, 2 Bath 993 SF
<b>B3</b>	THE PALERMO 2 Bed, 2 Bath 1,165 SF
<b>B4</b>	THE TRENTO 2 Bed, 2 Bath 1,285 SF
<b>B4 A</b>	THE TRENTO 2 Bed, 2 Bath 1,326 SF

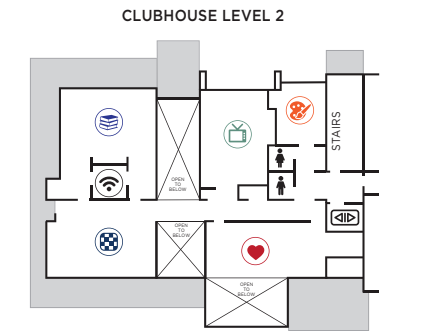
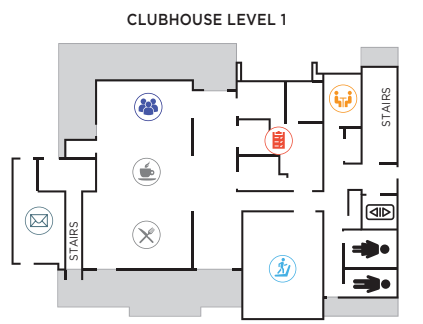

**CLUB HOUSE FIRST LEVEL AMENITIES**

- KITCHEN & DINING
- GREAT ROOM LOUNGE
- FITNESS CENTER
- MAIL ROOM
- COFFEE LOUNGE
- LEASING CENTER
- MEETING ROOM

**CLUB HOUSE SECOND LEVEL AMENITIES**

- LIBRARY
- BUSINESS CENTER
- GAME ROOM
- WELLNESS STUDIO
- CRAFT ROOM
- MEDIA ROOM

**OUTDOOR AMENITIES**

- POOL LOUNGE
- OUTDOOR SEATING
- OUTDOOR KITCHEN
- EVENT LAWN
- FOUNTAIN
- FIREPIT LOUNGE
- PICKLEBALL
- BOCCIE BALL
- DOG PARK

- GARAGE
- CARPORT
- RESTROOMS
- ELEVATOR
- TRASH
- STORAGE

**OUR COMMUNITY**





## LIFESTYLE & ENGAGEMENT

# THROUGH ACTIVE PARTICIPATION

Our Lifestyle & Engagement (L&E) program was designed to elevate the community living experience for our residents, extending far beyond the walls of their homes. It's our commitment to support a balanced lifestyle while fostering a sense of belonging in your community through social events, lifestyle programming and wellness classes.



## L&E PILLARS

### Sharpen Your Mind



TRIVIA GAMES



TECHNOLOGY COURSES



ARTS & CRAFTS



SOCIAL HOURS



LIFELONG LEARNING



PET EVENTS

### Strengthen Your Body



FITNESS CLASSES



WALKING GROUPS



COOKING DEMOS



HEALTH EDUCATION



GARDENING



DANCING

### Share Your Gifts



TEACH



HOST



PLAN



SUPPORT



SERVE



VOLUNTEER



# 55+ Active Adult Living

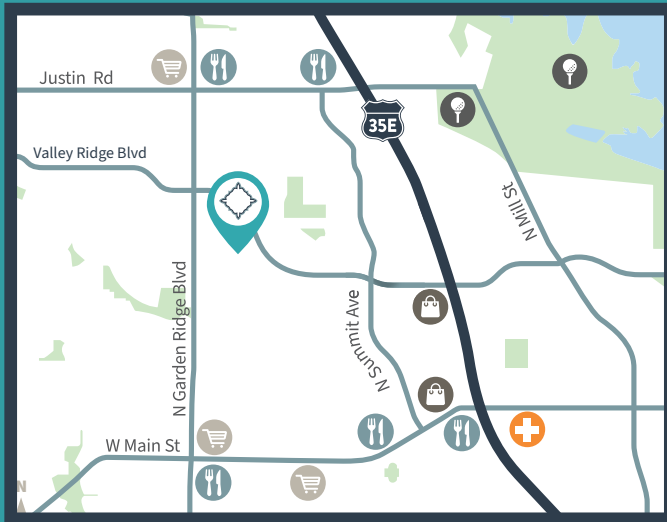

1450 Valley Ridge Blvd  
Lewisville, TX 75077  
SoleaLewisville@SparrowLiving.com  
(469) 457-2286

**SoleaLewisville.com**

